

Reference Photodiode

Introduction

Prizmatix reference photodiode is useful in order to monitor LED source power over time in experiments required exceptional stability over long time period.

The photodiode signal can be used to normalize measurements; alternatively the photodiode signal can serve as a feedback signal to stabilize the LED power.

The photodiode features low noise, high dynamic range. The photodiode comprises integrated high gain trans-impedance amplifier for direct connection to oscilloscope or to computer through A/D module.

The Photodiode is mounted inside threaded barrel compatible with Prizmatix OptiBlocks.



Key Features

- Suitable for direct installation [item 14] on Beam Combiner [item 2].
- Uses Beam Combiner stray light for measurement - No light losses
- Suitable for wide range of power supply voltages (3-30V)
- High dynamic range of measurement (0-28V)
- 3 wires cable: DC (+), DC (-), Signal



Optional: Low noise battery power supply and BNC Analog output for photodiode

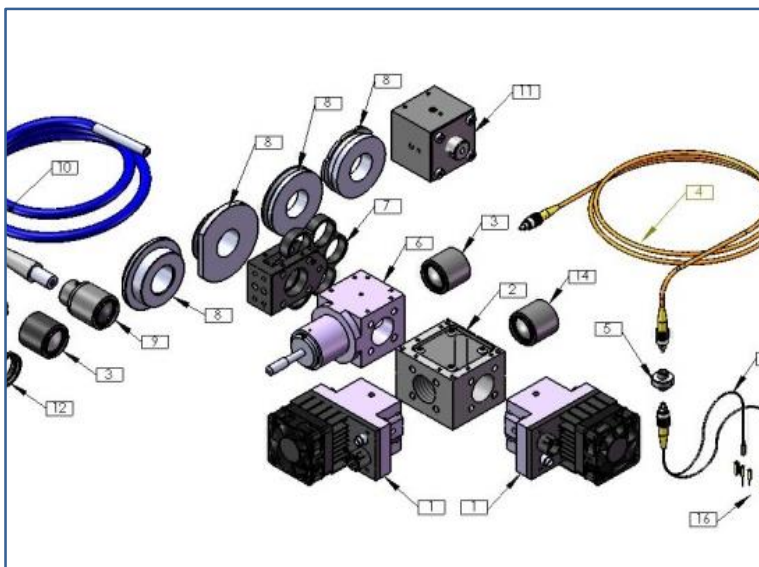

Main Office

Phone: +972-72-2500097
Fax: +972-72-2500096
sales@prizmatix.com

European Sales Office

Phone: +44 (0)77-9172-9592 Fax:
+44 (0)20-7681-2977
sales.europe@prizmatix.com

North America Sales Office

Phone: +1-(248)-436-8085
Fax: +1-(248)-281-5236
sales.usa@prizmatix.com